

# SPARK TECH TOES

Instructions and Setup Guide

## Compatibility:

Works with all splitboards using the industry standard touring bracket insert pattern.

**MADE IN THE USA**

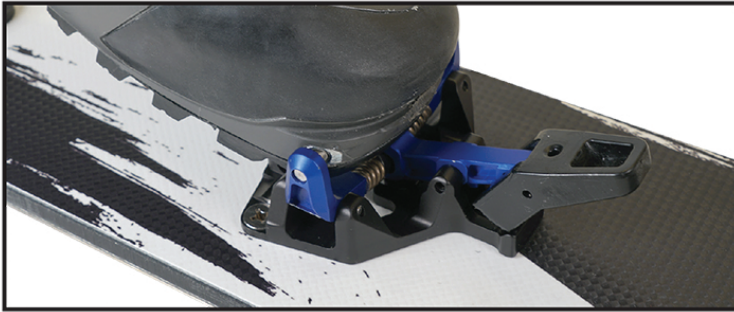

### Included Parts

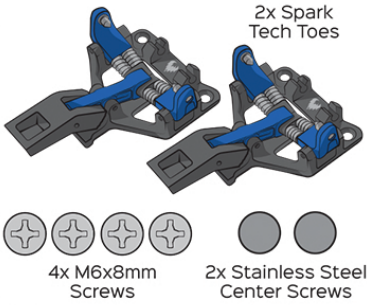

### Required Tools

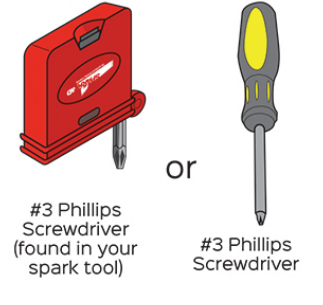

Start by tightening in the center screw into the forward most touring insert, by hand.

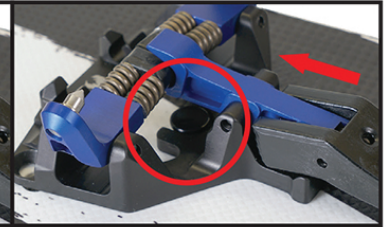
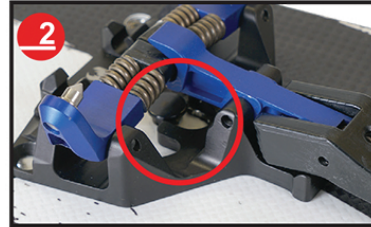
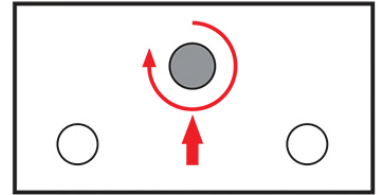

Set the center cutout of a tech toe over the center screw. Slide the notch in the cutout rearward under the head of the screw (you may need to rotate the tech toe to align the notch with the flats on the screw). If the screw is too tight to slide under, remove the tech toe and loosen by one rotation.

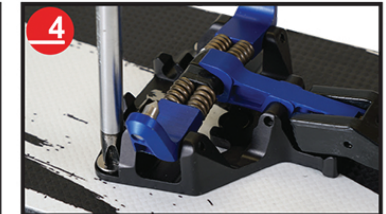
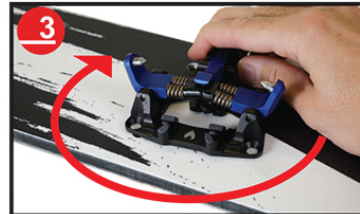

Using the tech toe as a wrench, tighten the center screw, ending the rotation so that the rear tech toe mounting holes line up with the board inserts and the center screw is tight.

Finish by installing two M6x8mm screws through the rear tech toe mounting holes.

**Note:** If the mounting holes don't line up when the toe piece is tight, you may need to unscrew the toe piece half a turn and reposition on a different set of center screw flats and repeat step 3.

## To Tour:

### 1 Click in

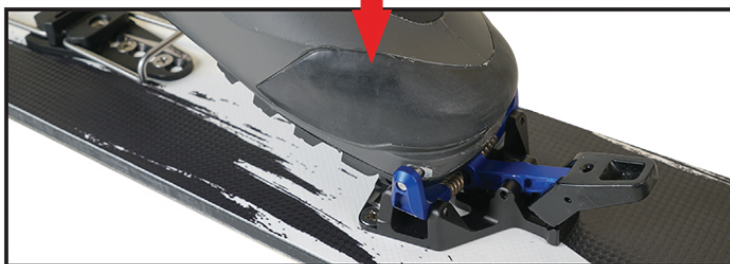
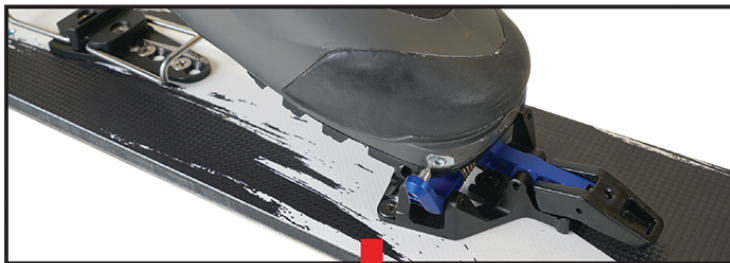

### 2 Lock

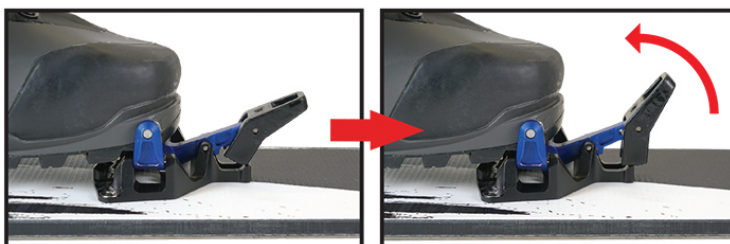

## To Release:

### Fully depress lock lever.



Go Splitboarding!